

**SHEAR BEAM LOAD CELL  
STANDARD CAPACITIES: 7500 KG.**

**MODEL SSB-R2-DT**



**MODEL SSB-R2-DT**

## **SPECIAL LOAD CELL FOR MOBILE WEIGHING**

- **LOAD CELL SERIE SSB SHEAR BEAMS FOR THE INDUSTRY**
- **3000 DIVISIONS O.I.M.L. R60, STANDARD CONDITIONS.**
- **SIMPLE TO INSTALL AND TO REPLACE**
- **FULLY WELDED STAINLESS STEEL, HERMETICALLY SEALE, TO IP 68**
- **CAPACITIES: 7500 KG**
- **LIGHTNING PROTECTION AVAILABLE**
- **FEET AND MOUNTINGS FOR ALL CAPACITIES AVAILABLE**
- **INDICATORS AVAILABLE, STANDARD AND STAINLESS STEEL, IP 67**

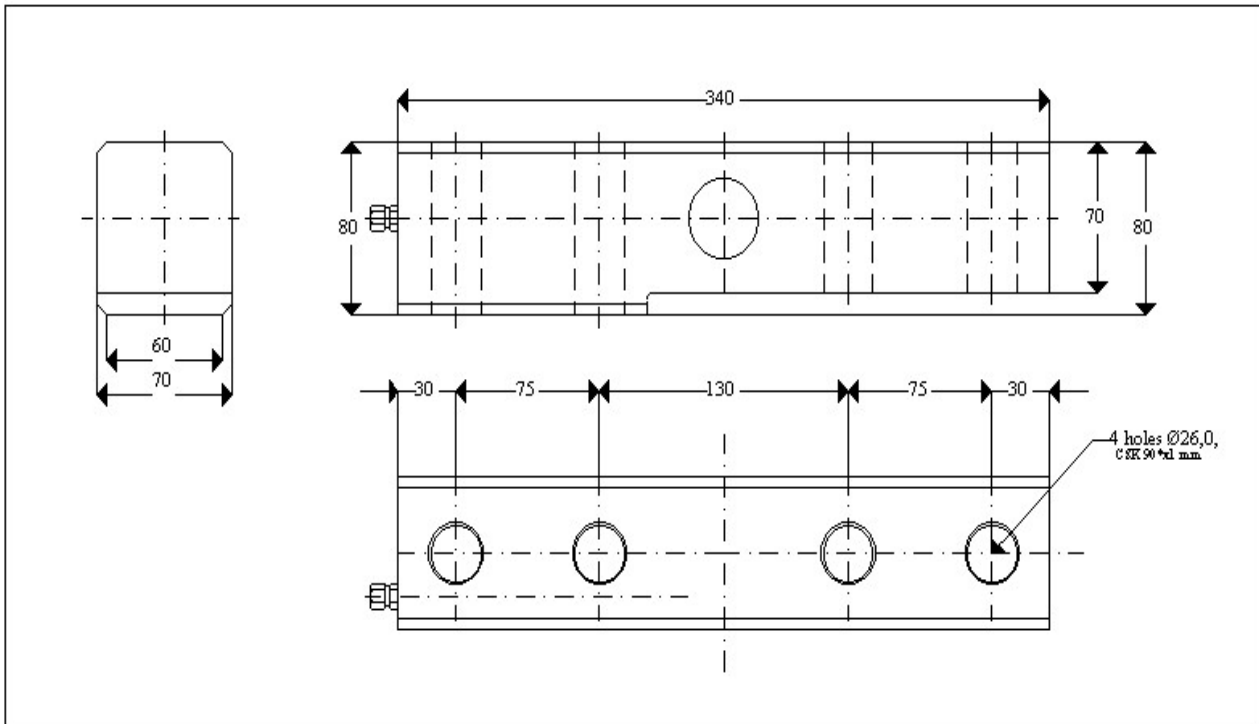

## SPECIFICATIONS

	UNITS	AMOUNT
Maximum capacity, (E <sub>max</sub> )	Kg.	7500
Accuracy class	OIML, C3	3000 DIVISIONS
Sensitivity	MV/V	1,2 +/-0,1%
Safe load limit (Elim.)	% of E <sub>max</sub>	>150
Linearity error	%	<+/-0,015
Apportionment factor	-	0,7
Repeatability	%	<+/-0,012
V. min.	%E <sub>max</sub>	0,006
Minimum dead load O/P return	%E <sub>max</sub>	0,0025
Temperature effects: Zero	%/°C	<+/-0,0012
Temperature effects: Span	%/°C	<+/-0,0010
Creep error, 30 Min.	%	<+/-0,015
Temperature rating	°C	-10 to +40
Nominal input voltage (Max)	V ac or dc	10 (15)
Input resistance	Ohm	400+/-25
Output resistance	Ohm	350+/-5
No load out put	%	<+/-2
Cable length	Meters	3, 5, 6
Insulation resistance	M ohms	>5000

## ELECTICAL CONNECTION

CABLE	POLYURETHANE; Ø5, 4 mm; 7 meter
+ EXCITATION	Green
- EXCITATION	Black
+ SIGNAL	White
- SIGNAL	Red